

Architectural Inventory Form

Official Eligibility Determination
(for OAHF use only)

Date _____ Initials _____
 Determined Eligible - National Register
 Determined Not Eligible - National Register
 Determined Eligible - State Register
 Determined Not Eligible - State Register
 Need Data
 Contributes to eligible National Register District
 Noncontributing to eligible NR District

I. Identification

1. Resource number: 5HN68.20
2. Temporary resource number: 25
3. County: Hinsdale
4. City: Lake City
5. Historic building name: First Baptist Church
6. Current building name: First Baptist Church
7. Building address: 401 Bluff Street, Lake City, CO 81235
8. Owner name and address: First Baptist Church, P.O. Box 515, Lake City CO 81235

II. Geographic Information

- County Property No.: RTax exempt
9. P.M. 6th Township 44N Range 4W NE4 of SW4 of SW4 of Section 27
 10. UTM reference
Zone 13 296620 mE 4211550 mN
 11. USGS quad name: Lake City Quad year: 1985 Map scale: X 7.5' ___ 15'
 12. Block(s): 0 Lot(s): 15-18 Legal:
Addition: Casco Addition Year of Addition: 1877
 13. Boundary description and justification: Perimeter of parcel

III. Architectural Description

14. Building plan: Irregular
15. Dimensions: 2044 square feet
16. Number of stories: 1-1/2
17. External wall material(s): Wood horizontal siding
18. Roof configuration: Gabled
19. Roof material: Metal
20. Special features: Porch, chimney, stained glass windows, decorative singles
21. General architectural description:

1-1/2 story, gabled frame building. Steeply pitched roof covered in metal; brick chimney at rear of north-south roof ridge. One-story gabled wing at northwest corner has brick chimney in roof ridge. Walls clad in shiplap siding and trimmed in cornerboards. Façade gable end has fish scale and diamond shingles, bargeboard and a small, round, 4-lite stained glass window with religious symbols. Windows are tall and narrow with stained glass and elaborate decorative frames with pedimented window hoods. Façade has paired windows with "1899" above. Masonry foundation covered in horizontal wood board.

Northeast ell contains a small vestibule surmounted by a steeple base. The steeple base is covered in fish scale and diamond shingles. It has a lower section with two small, 1-over-1, stained glass windows; the upper section has round-arched openings enclosed in louvers and a bracketed cornice with wood dentils. The steeple is covered in fish scale and diamond shingles, surmounted by a weather vane/lightning rod. The vestibule entrance has an east-facing entrance with paneled and glazed double doors, a transom, and a pedimented window hood. The entrance is sheltered by a cross-gabled, entry porch with a wood-shingled roof and elaborate decorative trim on the gable edges. One-story, gabled addition on rear is clad in shiplap siding, has shed-roofed porch supported by metal poles on north.

Interior walls are covered in beadboard wainscoting with wallpaper above. Beneath the altar is a 7' x 4' Baptismal font, about 4' deep, water perhaps warmed with heated boulders.

22. Architectural style/Building type: Carpenter Gothic

23. Landscaping or special setting:

The church occupies a long narrow parcel on an elevated site on Bluff Street. It is a visible landmark from various points on Bluff Street and Fourth Street.

24. Associated building, features or objects:

The Baptist Fellowship Hall and parsonage, located across the street at 400 Bluff and 418 Bluff, are also owned by the Baptist congregation.

IV. Architectural History

25. Date of construction Estimate: _____ Actual: 1891 Source of info: City PHONOGRAPH, February 27, 1892

26. Architect: Unknown Source of info:

27. Builder/contractor: Unknown Source of info:

28. Original owner: First Baptist Church Source of info:

29. Construction history (major additions, alterations, demolitions):

Steeple added after original construction, in the 1890s. Addition constructed on rear circa 1965. Foundation reinforced with masonry in 2002.

30. Original location: Moved Date of move(s) _____

V. Historical Associations

31. Original use(s): Church

32. Intermediate use(s): Vacant

33. Current use(s): Church

34. Site type(s):

35. Historical background:

Lake City Baptists organized in 1883 and used rented storerooms, "moving from dingy hall to smoky and forsaken store," until purchasing Lot 17, Casco Addition, for \$30 in 1889. The congregation embarked on an ambitious fundraising drive resulting in construction of the present church building in 1891. The lumber firm Guionneau & Youmans was general contractor on the project, starting with groundbreaking June 25, 1891, and formal dedication on January 17, 1892. Total cost was \$2,500, making it the most costly church in Lake City.

At completion it was described as "very tasty in appearance," and "one of the handsomest churches in the San Juan country." Its architectural style was described as "modern," composed of the auditorium within the central, front-gabled portion of the church and an "L" addition to the north housing a lecture room, and 45' tall steeple housing a belfry. Gable and steeple were covered with decorative cut shingles paneled barge boards on the gable ends.

Opera-style folding chairs on the interior provided seating for 102 in the auditorium and 35 in the lecture room. Other model features included a subterranean baptismal font, and a series of elaborate memorial windows in the Renaissance style. These windows were installed between 1892 and 1920, the first stained glass windows to be installed in a Lake City church. The memorials were described as "the very latest in glasswork, and are composed of a variety of glass convoluted, opalescent, translucent, in mild yet rich colors."

Windows in the church were dedicated included a double window in the front elevation in memory of Zurbiah Beemer by her daughter, Mrs. Hill Whitmore; W.H. Parker, presented by the church pastor, Rev. C.A. Parker, in memory of his brother; and three windows installed by Peter P. Kennedy in 1899, including two recalling his late wives, Carolina A. Kennedy and Mildred Taliaferro Kennedy. Two later, geometric-style stained glass windows from c. 1920 are preserved in the adjoining lecture room, the windows in memory of pioneers John S. Hough and his wife, Mary Prowers Hough.

First Baptist Church remained a prominent Lake City religious organization until 1920, after which -- mirroring the economic fortunes of Lake City -- it began a long decline. Through the late 1930s and 40s the building was virtually abandoned and became home to a band of burros who lived in the hall. Pioneer Jubilee Women's Club used a room in the church for the town library in the mid-1940s. Adjoining landowner George Edwards expressed an interest in demolishing the church to expand his new Matterhorn Motel, prompting local women Pearl Hunt McCloughan and Mabel Downing Rawson to mount a campaign to preserve the church.

The church was formally reorganized as a Southern Baptist Church in 1959, with summer resident R.L. Edmondson serving as pastor. A modern memorial window in the church vestibule recalls the efforts of Mrs. McCloughan and Mrs. Rawson to save the church building. The addition to the back of the church for dining and Bible study was completed in the 1960s. The church's congregation has steadily increased during the past 20 years, as is seen with a year-round pastor and expanded facilities such as the Baptist Fellowship Hall and parsonage which were built on lots across the street in the 1990s.

36. Sources of information:

Lake City PHONGRAPH, February 27, 1891, page 3; RECORDS OF FIRST BAPTIST CHURCH OF LAKE CITY, COLORADO, Minutes of trustee meetings 1883-1975; SILVER WORLD, June 19, 1981, page 5, July 15, 1983, page 6, August 2, 1991, page 8.

VI. Significance

37. Local landmark: Yes No Date of design.: _____ Design. authority: _____

Within Lake City Historic District (local historic district)

38. Applicable National Register Criteria:

- A. Associated with events that have made a significant contribution to the broad pattern of our history;
- B. Associated with the lives of persons significant in our past;
- C. Embodies the distinctive characteristics of a type, period, or method of construction, or represents the work of a master, or that possesses high artistic values, or represents a significant and distinguishable entity whose components may lack individual distinction; or
- D. Has yielded, or may be likely to yield, information important in history or prehistory
- Qualifies under Criteria Considerations A through G
- Does not meet any of the above National Register criteria

39. Area(s) of significance: Social history, religion, architecture

40. Period of significance: 1891 -1904

41. Level of significance: National State Local

42. Statement of significance:

This building is associated with settlement and development of Lake City during the late 1800s mining era. The church also reflects the strong community spirit in the town. Unlike other mining camps where saloons far outnumbered churches, early Lake City had a number of churches, four of which remain well preserved today.

The church is a well-preserved representative of the Carpenter Gothic style constructed in Lake City during this period, as reflected in its steeply pitched gabled roof, decorative shingles, bargeboard, elaborate window frames, and cross-gabled entry porch with elaborate gable edge trim.

43. Assessment of historic physical integrity to significance:

The architectural integrity of this dwelling is intact, as evidenced by minimal alterations to its character-defining features.

VII. National Register Eligibility Assessment

44. National Register eligibility field assessment: Eligible Not Eligible Need Data

45. Is there National Register district potential? Yes No

Discuss _____

If there is National Register district potential, is this building Contributing Noncontributing

46. If the building is in an existing National Register district is it? Contributing Noncontributing
(Lake City National Historic District)

VIII. Recording Information

47. Photograph numbers: Roll 3, frame 18A-24A Negatives filed at: Lake City Town Hall

48. Report title: 2003 Architectural Survey of Lake City, Colorado

49. Date(s): September 2002 - June 2003

50. Recorders Cathleen M. Norman and Grant E. Houston

51. Organization: Town of Lake City

52. Address: 230 Bluff Street, Lake City CO 81235 53. Phone no. (970) 944-2333

Colorado Historical Society - Office of Archaeology and Historic Preservation
1300 Broadway, Denver CO 80203 (303) 866-3395



CASCO ADDITION

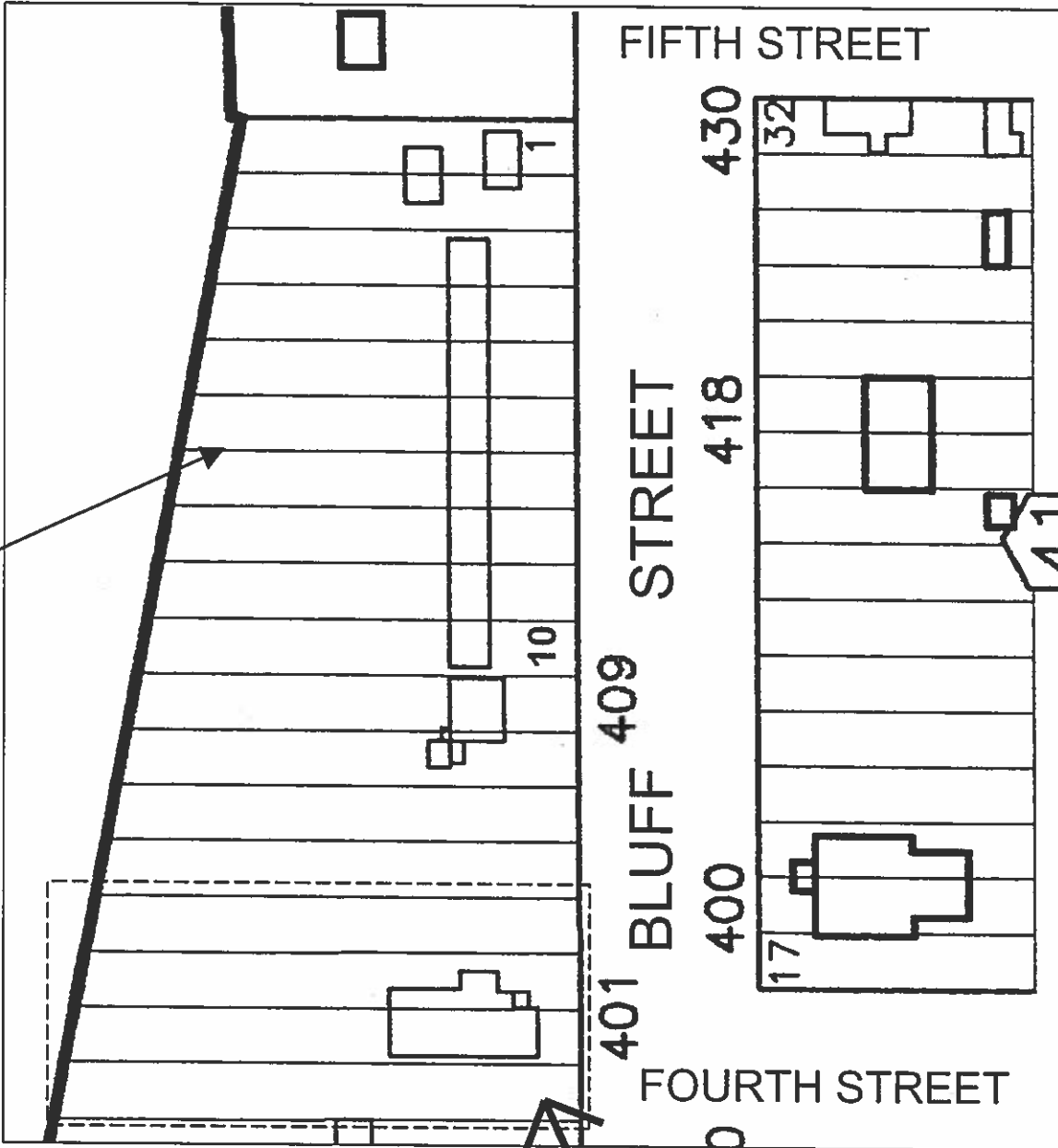

NOT TO SCALE